

Ratio 1:1
Flow rate 30 l/min



P/N OE33360

P/N OE33396

S/STEEL AISI 304 PUMPS FOR TRANSFER ANTIFREEZE LIQUID, WINDSHIELD WASHING LIQUID S. 600

P/N	OE33360	OE33396
Seals	Viton®	
Compatible fluids	Suitable for antifreeze and windshield washing liquid	
Suction tube upper body	Stainless steel AISI 304	
Suction tube	Stainless steel AISI 304	
Air inlet connection	F1/4"G	F1/4"G
Fluid outlet connection	F1/2"G	F1/2"G
Air working pressure	bar	6 - 8
Average air consumption	l/min	370
Noise level	dB	81
Max deliverable oil viscosity	SAE	50
Bung adaptor	-	OE33434
Suitable for drums or tank	modular	for drums 180 - 220 Kg
Packing	No. - m ³	1 - 0,10
Weight	Kg	5,3
Dimensions (A x B x C)	mm	410 - 0 - 0

PUMP AIR FEEDING PRESSURE
A 8 bar (116 psi)
B 6 bar (87 psi)
C 4 bar (58 psi)

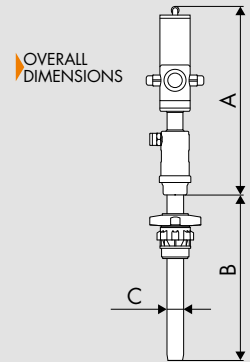
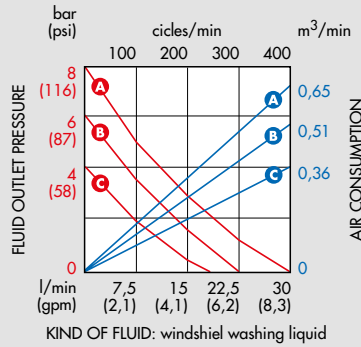

Ratio 1:1
Flow rate 30 l/min



P/N OE33300

S/STEEL AISI 304 MODULAR PUMPS FOR TRANSFER ANTIFREEZE LIQUID, WINDSHIELD WASHING LIQUID S. 600

P/N	OE33300	OE33301
Seals	Viton®	
Compatible fluids	Suitable for antifreeze and windshield washing liquid	
Suction tube upper body	Stainless steel AISI 304	
Suction tube	Stainless steel AISI 304	
Air inlet connection	F1/4"G	F1/4"G
Fluid outlet connection	F1/2"G	F1/2"G
Air working pressure	bar	6 - 8
Average air consumption	l/min	370
Noise level	dB	81
Max deliverable oil viscosity	SAE	50
Bung adaptor	OE33434	OE33434
Suitable for drums or tank	for drums 200 L	for tank 1000 L
Packing	No. - m ³	1 - 0,29
Weight	Kg	11,4
Dimensions (A x B x C)	mm	410 - 940 - 34

PUMP AIR FEEDING PRESSURE
A 8 bar (116 psi)
B 6 bar (87 psi)
C 4 bar (58 psi)

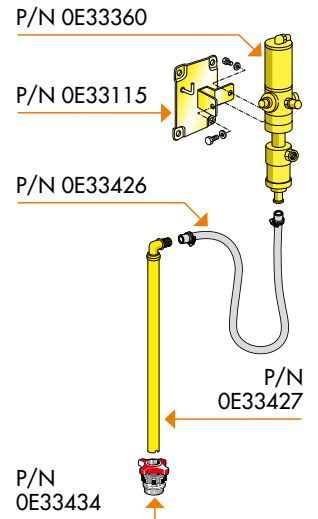
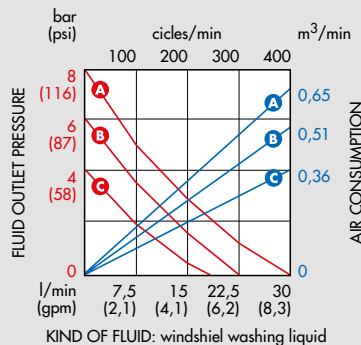

P/N OE33445

Antifreeze and windshield liquid gun in alluminium S. 1/2" 40AN with Viton® seals

